

**ORDER GRANTING PERMIT AND RIGHT-OF-WAY  
TO CONSTRUCT PIPELINE, ROAD CROSSING, AND/OR ROAD CUT**

Now, on this 28th day of March, 2022 at a regular session of the Commissioners' Court of Clay County, Texas, came on to be considered the application of (contractor) Spectrum / Charter Texas, (address) 1565 Chenault St, Dallas, Texas 75228 (telephone #) 214-629-0606, hereafter referred to as "contractor", for a permit and right-of-way to lay, construct, maintain, operate or remove a pipeline, road crossing, and/or road cut, along, over and across or under the public roads, streets, alleyways or highways in the County of Clay, State of Texas, described on the plat attached, and the court having considered such application, it is accordingly ORDERED by the Court:

1. That the County of Clay, State of Texas, does hereby grant the right, privilege, and right-of-way to contractor to lay, construct, maintain, operate and/or remove a pipeline, road crossing, and/or road cut, along, over, across or under the public roads, streets, alleyways of the County of Clay, State of Texas, as described in the plat attached.

X (please check if roads are to be bored)

2. That such pipeline, road crossing, and/or road cut, shall be buried, covered, constructed, and maintained as not to interfere with the uses and occupancy of such roads by the public and shall be buried at least three (3') feet below the present barditch on said county road.
3. That any adjustment of said pipeline, road crossing, and/or road cut, required for any state farm to market road or any other improved road would be at 100% percent cost to contractor.
4. That all the rights, privileges and right-of-ways hereinabove mentioned are by this order duly vested in the said contractor, its successors, and assigns, without any further grant or procedure.
5. That contractor shall restore roadway and/or right-of-way to its previous condition; and/or shall pay to Clay County, Texas reasonable compensation for the restoration of said roadway and/or right-of-way.

✓  
**(check if applicable) an agreed payment as reasonable compensation in the amount of payable by contractor to Clay County, Texas. (\$500.00 or two (2) loads of base material to the commissioner's specifications changes is approved)**

Agreed and Accepted:

Spectrum / Charter  
Contractor

By: [Signature]  
Name and Title Scott Rone, Construction Coordinator

STATE OF TEXAS §

COUNTY OF CLAY §

Before me, the undersigned authority, on this day personally appeared Scott Rone, known to me to be the person whose name is subscribed to the foregoing instrument and acknowledged to me that he executed the same for the purposes and consideration therein expressed and, in the capacity, therein stated.

Given under my hand and seal of office this 16<sup>th</sup> day of March, 2022.

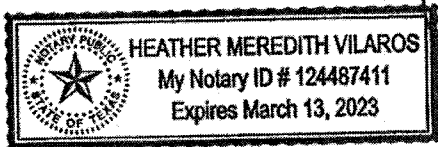

[Signature]  
Notary Public in and for Dallas County, Texas

\* \* \* \* \*

[Signature]  
Mike Campbell, County Judge

STATE OF TEXAS §

COUNTY OF CLAY §

Before me, the undersigned authority, on this day personally appeared Mike Campbell known to me to be the person whose name is subscribed to the foregoing instrument and acknowledged to me that he executed the same for the purposes and consideration therein expressed and, in the capacity, therein stated.

Given under my hand and seal of office this 28<sup>th</sup> day of March, 2022.

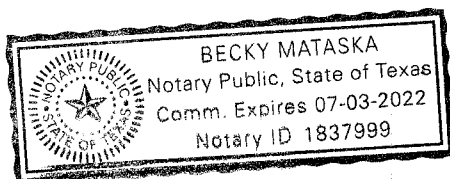

[Signature]  
Notary Public in and for Clay County, Texas



NOTE  
CONTRACTOR IS RESPONSIBLE TO MAINTAIN TRAFFIC CONTROL DEVICES AS SET FORTH IN THE TEXAS MANUAL ON UNIFORM TRAFFIC CONTROL DEVICES FOR STREETS AND HIGHWAYS

Clay County Notes: conduit shall be placed a minimum of 36" below grade.  
ALL CROSSINGS TO BE BORED NOT TRENCHED

PID 3286638

Underground crossings on Lechner Rd

Project consist of approximately:

68' of Underground Fiber

**GENERAL CONSTRUCTION NOTES**

1. ALL CONSTRUCTION WORK WITHIN THE PUBLIC RIGHT-OF-WAY SHALL BE DONE IN ACCORDANCE WITH THE ORDINANCES AND REGULATIONS OF THE MUNICIPALITY IN WHICH THE WORK IS TO BE PERFORMED.
2. EXISTING UTILITY CONDITIONS SHOWN ARE TAKEN FROM AVAILABLE RECORDS AND MAY NOT BE ALL INCLUDING LOCATION OF EACH PARTICULAR UTILITY. THE CONSTRUCTION CONTRACTOR SHALL ASSUME RESPONSIBILITY FOR THE LOCATION OF ALL UTILITIES. THE CONSTRUCTION CONTRACTOR SHALL ALSO ASSUME RESPONSIBILITY FOR REPAIRS TO ANY EXISTING FACILITY AS A DIRECT RESULT OF THE CONSTRUCTION ACTIVITIES WHETHER THE FACILITY IS SHOWN ON THE DRAWINGS OR NOT.
3. THE CONSTRUCTION CONTRACTOR SHALL BE RESPONSIBLE FOR CONTACTING ALL DEPARTMENTS WITHIN THE MUNICIPALITY AND THE UTILITY COMPANIES AT LEAST TWO WORKING DAYS PRIOR TO THE COMMENCEMENT OF WORK.
4. IT SHALL BE THE RESPONSIBILITY OF THE CONSTRUCTION CONTRACTOR TO: A) PREVENT DAMAGE TO PRIVATE AND PUBLIC PROPERTY, B) RESTORE ALL AREAS EFFECTED BY THE CONSTRUCTION TO ORIGINAL OR BETTER CONDITION.

CALL BEFORE YOU DIG

811

IT'S THE LAW

5. BARRICADING AND TRAFFIC CONTROL SHALL BE THE RESPONSIBILITY OF THE CONSTRUCTION CONTRACTOR AND SHALL CONFORM TO THE TEXAS MANUAL ON UNIFORM TRAFFIC CONTROL DEVICES. TRAFFIC FLOW AND ACCESS TO THE PROJECT SHALL BE MAINTAINED AT ALL TIMES. THE CONSTRUCTION CONTRACTOR SHALL BE RESPONSIBLE FOR PROVIDING TRAFFIC SAFETY MEASURES FOR WORK ON THE PROJECT. THE WORK SITE SHALL BE SUITABLY UT AND BARRICADED AT NIGHT.
6. THE CONSTRUCTION CONTRACTOR SHALL ABIDE BY ALL APPLICABLE FEDERAL, STATE AND LOCAL LAWS GOVERNING ALL ASPECTS OF WORK RELATED TO EXCAVATION.
7. ALL CONCRETE USED IN ANY ROADWAY SHALL BE IN COMPLIANCE WITH THE SPECIFIED CLASSES OF CONCRETE IN THE TEXAS MANUAL ON UNIFORM TRAFFIC CONTROL DEVICES. ALL CONCRETE SHALL BE PLACED AND FINISHED AS SPECIFIED BY THE DRAWINGS TO THE WORK. ALL CONCRETE SHALL BE CLASS A CONCRETE. ALL REINFORCING STEEL AND DOWEL BARS IN PAVEMENT SHALL BE SUPPORTED AND MAINTAINED AT THE CORRECT CLEARANCES BY THE USE OF BAR CHAIRS OR OTHER APPROVED SUPPORT.
8. ALL CONDUIT MUST BE PLACED WITH A MINIMUM 42" OF COVER, UNLESS OTHERWISE SPECIFIED.
9. ALL BUCKELINGS WILL BE MECHANICALLY TAMPED IN LETS TO A DENSITY OF 95% PROCTOR. THE REQUIRED DENSITY WILL BE OBTAINED BY USING TAMPERS, RAMMERS OR ROLLING EQUIPMENT. LETS MAY VARY ACCORDING TO THE TYPE OF EQUIPMENT USED TO OBTAIN THE REQUIRED DENSITY. SAND AND DEBRIS FREE MATERIAL WILL BE USED FOR BACKFILL.

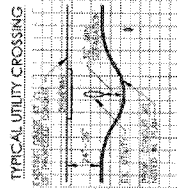
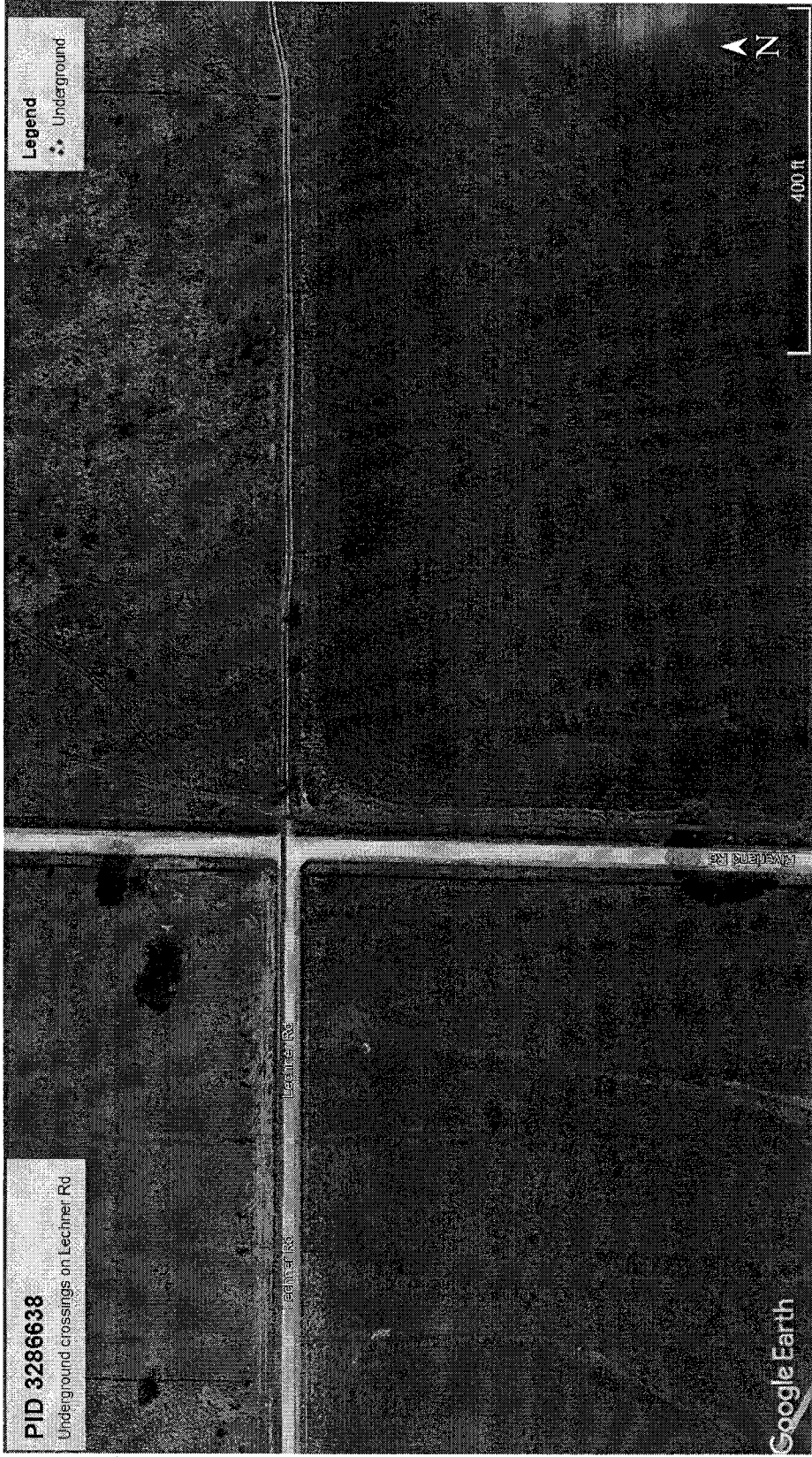

UNDERGROUND CONDUIT 1-2" HDPE

